

Taylor C707BK: Stage 1 Cleaning Process

Words in **GREEN** signifies "ON"
Words in **RED** signifies "OFF"

1 Drain Product



- **Standby Mode**
- **Mix Refrigeration**
- Remove feed tube & empty product
- Refrigerate or discard

2 Clean Hopper



- **Wash Mode**
- Clean top hopper, lid & feed tube
- Brush mix inlet hole
- Fill freezing cylinder with wand
- **Wash Mode** wait 2-3 minutes

3 Drain Pre-wash & Remove Draw Valve



- Drain pre-wash
- **Wash Mode**
- Remove draw valve & prime plug
- Spray each opening
- Clean & re-install prime plug

4 Install Bypass System



- Spray off bypass tube
- Insert into mix inlet hole
- Terminate bypass hose to a suitable drain
- Clean & replace hopper lid

5 Install Pro-control Module



- Clean bottom of freezer door
- Wet all O-rings
- Install Pro-control
- Engage keeper switch
- Connect water supply

6 Install LEXX™ Cups



- Install 1 LEXX™ cup into each cup housing

7 Start the Pro-control



- **"ONE TOUCH"** to initialize the Pro-control cycle
- Audible beeps from Pro-control
- **Wash Mode**
- Clean any removed components
- **If performing 15 day clean, flip to back**

8 Pro-control Cycle Complete



- "GREEN LED" blinks, cycle is done
- Press & release **"PLAY/PAUSE"**
- **Wash Mode**
- Disconnect water supply
- Empty (R) cup housing and replace
- Remove (L) cup housing over bucket
- Raise prime plug to drain
- **Wash Mode** momentarily
- Re-attach cup housing
- Disengage keeper switch & remove the Pro-control

9 Sanitize Freezer Door & Re-install Draw Valve



- Clean prime plug, freezer door & all openings
- Disconnect bypass system
- Re-install draw valve & prime plug
- Leave feed tube out
- Perform self-clean on Pro-control

10 Prime Machine



- Place a bucket under the freezer door & open prime plug
- Pour mix into hopper & hold draw valve open
- When only fresh mix is flowing, close draw valve
- When steady stream of mix flows from prime plug opening, close prime plug
- Re-install feed tube
- Replace hopper lid
- **Auto Mode**

HYDRA RINSE

Words in **GREEN** signifies "ON"
Words in **RED** signifies "OFF"

- | | | | |
|--|-----------|--|-----------|
| | = OFF | | = MIX REF |
| | = ON | | = STANDBY |
| | = MIX LOW | | = WASH |
| | = MIX OUT | | = AUTO |

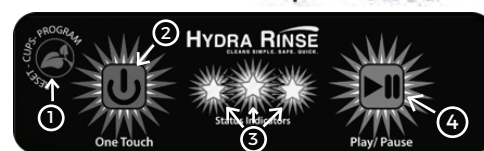

- "Reset-Cups-Program"**
 - Reset
 - Register Cleaning Cycles
 - Read # of Cleanings Available
- "ONE TOUCH"**
 - Initialize Cleaning Cycles
 - Self-Clean Mode when used simultaneously w/ "PLAY/PAUSE"
- "Status Indicators" LEDs**
 - Power On/Cycle Initiated
 - Cycle Paused
 - Errors
 - # of Registered Cleanings
- "PLAY/PAUSE"**
 - Cancel/Conclude Cleaning
 - Pause/Resume Cleaning
 - Self-Clean Mode when used simultaneously w/ "ONE TOUCH"

Refer to the Manual for Full Instructions

Registration of Token Tag

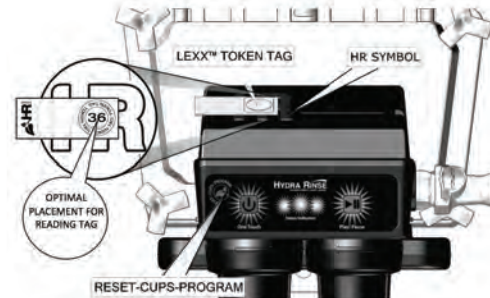

- To register, hold the "TOKEN TAG" on the "HR Symbol"
- Keep "TOKEN TAG" in position, press and release the "RESET-CUPS-PROGRAM" button
- LED's will illuminate
- Once registered, a "Beep" will be heard & the "Status Indicators" blinking the number of stored cycles
- To finish, remove the "TOKEN TAG" from the registration zone, press and then release the "RESET-CUPS-PROGRAM" button
- The Pro-control is ready to use

Taylor C707BK:
15 Day Cleaning &
Disassembly Process

Words in **GREEN** signifies "ON"
Words in **RED** signifies "OFF"

These steps are
to be performed
every 15 days
after completing
Step 7 in the
Stage 1 Process

1 Pro-control Cycle Complete

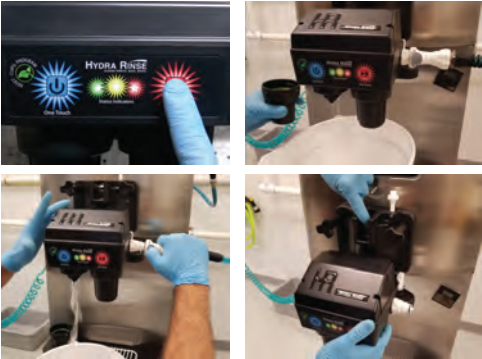

- "GREEN LED" blinks, cycle is done
- Press & release "PLAY/PAUSE"
- **Wash Mode**
- Disconnect water supply
- Empty (R) cup housing and replace
- Remove (L) cup housing over bucket
- Raise prime plug to drain
- **Wash Mode** momentarily
- Re-attach cup housing
- Disengage keeper switch & remove the Pro-control

2 Remove & Clean Internal Components

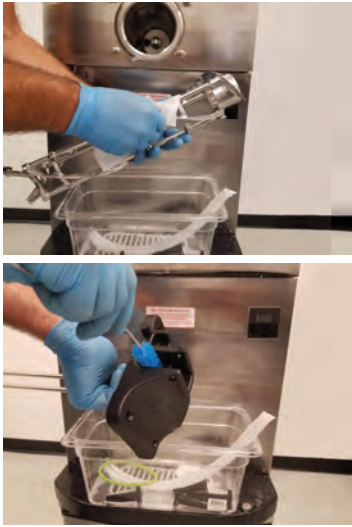

- **Main Power**
- Remove the freezer door & all internal components
- Clean the cylinder & all components using the wand, wipes & brushes
- Brush clean all door openings

3 Inspect Components



- Inspect front bearing and scraper blades for wear
- Replace if necessary

4 Re-lube & Re-install Drive Shaft



- Re-install rear shaft seal
- Apply lube to smooth part of drive shaft, avoiding hex end
- Re-install drive shaft

5 Re-assemble Machine



- Re-install all internal components, freezer door and draw valve
- **Main Power**

6 Re-sanitize Cylinder and Internal Components



- Fill freezing cylinder with wand
- **Wash Mode** wait 2-3 minutes
- **Wash Mode**
- Drain sanitizing solution
- **Revert to Stage 1 Step 10 to complete**

Hydra Rinse:
Pro-Control Self Clean

1 Prep Pro-Control



- Connect water supply to Pro-Control
- Hold Pro-Control upside down with Pistons over a bucket

2 Initiate Self Clean

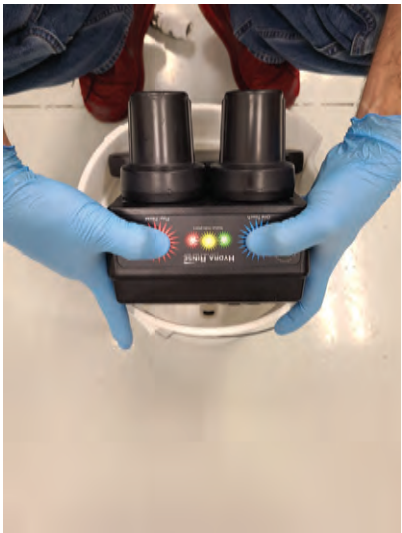

- Press and hold "ONE TOUCH" and "PLAY/PAUSE" for ~5secs
- All 3 led's illuminate, release buttons
- Flush cycle is approx. 30secs

3 Empty Pro-Control



- LED's will turn off, cycle is complete
- Disconnect water supply
- Empty cup housings