

# HYDRA RINSE Stoelting U421: Stage 1 Cleaning Process

\*Please refer to manual for full instructions\*

Words in **GREEN** signifies "ON"  
Words in **RED** signifies "OFF"

## 1 Drain Product



- **Sleep Mode**, wait 4-5 hours
- Disconnect product mix bags and refrigerate
- Remove product drawers/buckets
- Drain product and discard

## 2 Pre-wash the Freezing Cylinders



- Install 2 buckets in lower cabinet w/ 1 gallon of LEXX™ solution in front bucket
- Place mix-in bag adapter in the solution
- **Pump**
- Fill freezing cylinder with LEXX™
- Continue refilling the front bucket with LEXX™, about 1 gallon
- **Pump & Clean Mode**

## 3 Drain Pre-wash, Remove Spigots



- After 2 minutes, **Clean Mode**
- Drain freezer cylinder
- Remove spigot
- Clean air bleed valve and spigot port with wand

## 4 Prep Lower Cabinet



- Disconnect the check valve block
- Remove spring check and duck bill check valve, if equipped, for cleaning
- Clean openings of block manifold

## 5 Connect Bypass Assembly

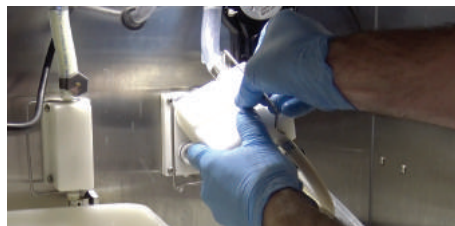

- Connect manifold block to the bypass manifold
- Install the drain line to a suitable drain

## 6 Install Pro-control

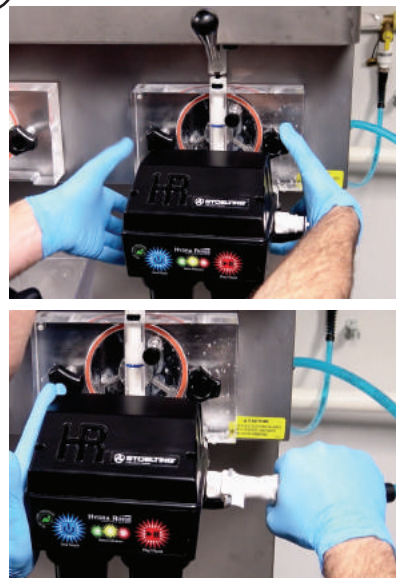

- Clean bottom of freezer door
- Wet all O-rings on Pro-control
- Install Pro-control
- Engage keeper switch to secure
- Connect water supply

## 7 Install LEXX™ Cups



- Install 1 LEXX™ cup into each cup housing

## 8 Start the Pro-control



- **"ONE TOUCH"** to initiate the Pro-control cycle
- Immediately push & hold the air bleed valve open until the freezing cylinder fills up to it
- Audible beeps from Pro-control, **Clean Mode & Pump**

## 9 Clean Ancillary Components

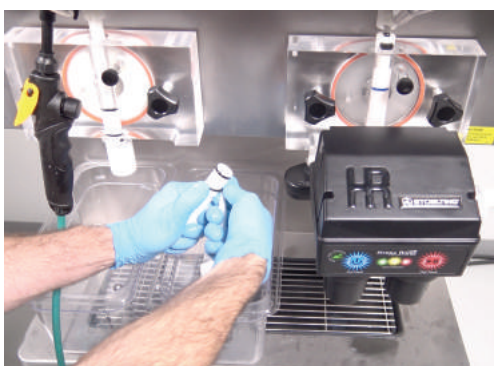

- **Pump** when front bay is empty
- Use remaining time to clean and sanitize removed components
- **If performing Stage 2, flip to back**

## 10 Pro-control Cycle Complete & Remove Bypass



- "GREEN LED" blinks, cycle is complete
- Press & release **"PLAY/PAUSE"**
- **Clean Mode**
- Remove left cup housing to drain
- Disconnect bypass manifold and drain into rear bucket
- Reattach left cup housing

## 11 Reassemble Lower Cabinet



- Remove bypass, re-install spring valve checks, duck bill check & re-connect check valve block
- Drain & re-attach the right cup housing

## 12 Remove Pro-control & Re-install Components



- Disconnect water supply, slide keeper switch to the middle & remove the Pro-control
- Clean spigot port
- Re-install the spigot
- Re-fill machine with product
- Run self clean on Pro-control

# HYDRA RINSE Stoelting U421: Stage 2 Cleaning Process

\*Please refer to manual for full instructions\*

Words in **GREEN** signifies "ON"  
Words in **RED** signifies "OFF"

## 1 Pause the Pro-control



- All 3 LED's start blinking about 3 ½ minutes into the cycle
- **"Play/Pause"**
- **Clean Mode**
- **Main Power**

## 2 Drain the Machine

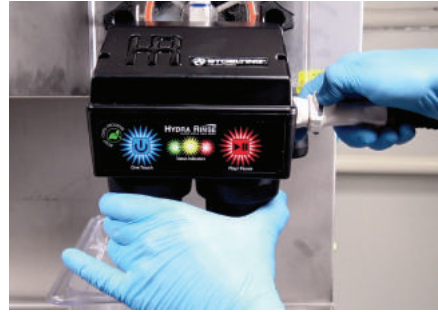

- Disconnect water supply
- Remove left cup housing to drain

## 3 Drain & Disconnect Bypass



- Drain the freezing cylinders by disconnecting the check valve block from bypass & drain into bucket
- Disconnect the mix delivery system

## 4 Clean & Reassemble Mix Delivery System

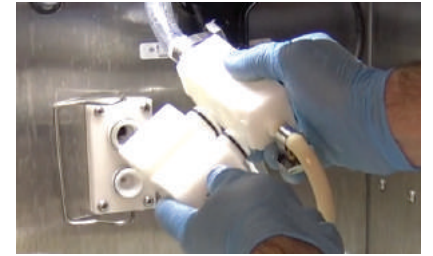
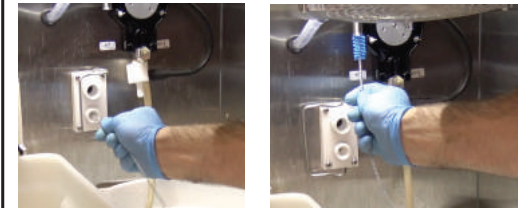

- Manually clean & sanitize mix delivery system
- Brush clean the mix feed tube
- Completely re-assemble and re-install the bypass

## 5 Remove Pro-control

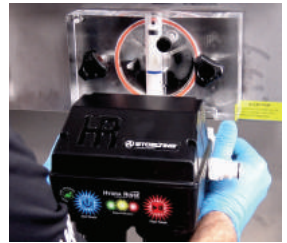

- Re-install the left cup housing
- Remove the Pro-Control & set aside (do not push any additional buttons)
- Pro-Control will beep & green LED will blink while paused

## 6 Remove & Clean Internal Components

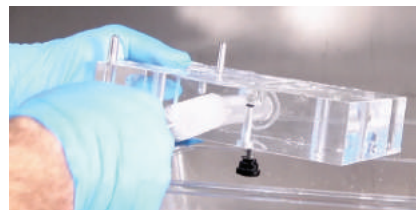

- Remove the front door & all internal components
- Clean removed components using the wand, wipes and brushes
- Brush clean all door openings

## 7 Reassemble Machine

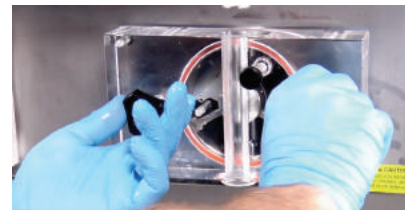

- When all parts have been cleaned & sanitized:
- Reapply the proper lubricant to all appropriate parts
- Re-assemble the machine

## 8 Re-install Pro-control



- Re-install the Pro-Control & connect the water supply
- Check that the water is still turned on & the bypass is properly installed

## 9 Resume Stage 1 Cleaning



- **Main Power**
- **"PLAY/PAUSE"**
- Hold the air bleed valves open until cylinder is full
- **Clean Mode**
- The Pro-Control will now start its sanitizing cycle
- **Revert to Stage 1 Step 10 to complete**